

FEMALE TUBE ADAPTER

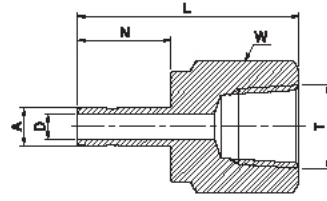

A Tube O.D.	T NPT	D	W Hex. flat	N	L
mm	in	mm	mm	mm	mm
3	1/8	2.1	14	13.5	31.5
3	1/4	2.1	19	13.5	35.3
4	1/4	2.2	19	14.2	35.0
6	1/8	4.0	14	15.7	32.5
6	1/4	4.0	19	15.7	36.5
6	3/8	4.0	22	15.7	39.6
6	1/2	4.0	27	15.7	45.5
8	1/8	5.6	14	16.9	34.3
8	1/4	5.6	19	16.9	37.6
8	1/2	5.6	27	16.9	46.0
10	1/4	7.1	19	17.6	38.1
10	3/8	7.1	22	17.6	40.1
10	1/2	7.7	27	17.6	46.5
12	1/4	8.8	19	23.3	43.4
12	3/8	8.8	22	23.3	45.5
12	1/2	8.8	27	23.3	52.3
16	3/8	12.7	24	24.7	48.0
16	1/2	12.7	27	24.7	53.1
20	1/2	15.1	27	26.6	56.0
20	3/4	15.1	35	26.6	56.0

FEMALE TUBE ADAPTER

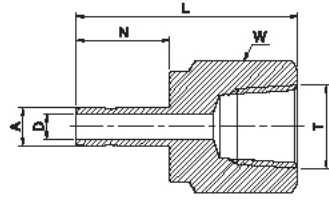

A Tube O.D.		T NPT	D		W Hex. flat		N		L	
in	mm	in	in	mm	in	mm	in	mm	in	mm
1/8	3.17	1/8	0.08	2.2	9/16	14.3	0.53	13.5	1.24	31.5
1/8	3.17	1/4	0.08	2.2	3/4	19.1	0.53	13.5	1.39	35.3
3/16	4.76	1/4	0.12	3.0	3/4	19.1	0.56	14.2	1.41	35.8
1/4	6.35	1/8	0.17	4.2	9/16	14.3	0.62	15.7	1.30	33.0
1/4	6.35	1/4	0.17	4.2	3/4	19.1	0.62	15.7	1.46	37.1
1/4	6.35	3/8	0.17	4.2	7/8	22.2	0.62	15.7	1.55	39.4
1/4	6.35	1/2	0.17	4.2	1-1/16	27.0	0.62	15.7	1.79	45.5
5/16	7.93	1/4	0.24	6.0	3/4	19.1	0.67	16.9	1.48	37.6
3/8	9.52	1/8	0.27	6.85	9/16	14.3	0.69	17.5	1.35	34.3
3/8	9.52	1/4	0.27	6.85	3/4	19.1	0.69	17.5	1.50	38.1
3/8	9.52	3/8	0.27	6.85	7/8	22.2	0.69	17.5	1.59	40.4
3/8	9.52	1/2	0.27	6.85	1-1/16	27.0	0.69	17.5	1.84	46.7
1/2	12.70	1/4	0.37	9.4	3/4	19.1	0.92	23.3	1.71	43.4
1/2	12.70	3/8	0.37	9.4	7/8	22.2	0.92	23.3	1.79	45.5
1/2	12.70	1/2	0.37	9.4	1-1/16	27.0	0.92	23.3	2.04	51.8
5/8	15.87	1/2	0.50	12.7	1-1/16	27.0	0.97	24.7	2.09	53.1
3/4	19.05	1/2	0.59	15.0	1-1/16	27.0	0.97	24.7	2.08	52.8
3/4	19.05	3/4	0.59	15.0	1-5/16	33.3	0.97	24.7	2.16	54.9
3/4	19.05	1	0.59	15.0	1-5/8	41.3	0.97	24.7	2.30	58.4
1	25.40	3/4	0.80	20.3	1-5/16	33.3	1.30	33.0	2.39	60.7
1	25.4	1	0.8	20.3	1-5/8	41.3	1.3	33	2.53	64.3
1-1/4	31.75	1-1/4	1.02	25.9	2-1/8	54	1.72	43.9	3.06	77.7
1-1/2	38.1	1-1/2	1.25	31.8	2-3/8	60.3	2.06	52.5	3.5	88.9
2	50.8	2	1.72	43.7	2-7/8	73.03	2.73	69.4	4.22	107.44

FEMALE TUBE ADAPTER

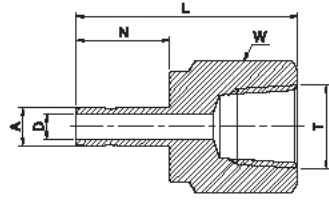

A Tube O.D.		T ISO	D		W Hex. flat		N		L	
in	mm	in	in	mm	in	mm	in	mm	in	mm
1/8	3.17	Rc 1/8	0.08	2.2	9/16	14.3	0.53	13.5	1.24	31.5
1/8	3.17	Rc 1/4	0.08	2.2	3/4	19.1	0.53	13.5	1.39	35.3
3/16	4.76	Rc 1/4	0.12	3.0	3/4	19.1	0.56	14.2	1.41	35.8
1/4	6.35	Rc 1/8	0.17	4.2	9/16	14.3	0.62	15.7	1.30	33.0
1/4	6.35	Rc 1/4	0.17	4.2	3/4	19.1	0.62	15.7	1.46	37.1
1/4	6.35	Rc 3/8	0.17	4.2	7/8	22.2	0.62	15.7	1.55	39.4
1/4	6.35	Rc 1/2	0.17	4.2	1-1/16	27.0	0.62	15.7	1.79	45.5
5/16	7.93	Rc 1/4	0.24	6.0	3/4	19.1	0.67	16.9	1.48	37.6
3/8	9.52	Rc 1/8	0.27	6.85	9/16	14.3	0.69	17.5	1.35	34.3
3/8	9.52	Rc 1/4	0.27	6.85	3/4	19.1	0.69	17.5	1.50	38.1
3/8	9.52	Rc 3/8	0.27	6.85	7/8	22.2	0.69	17.5	1.59	40.4
3/8	9.52	Rc 1/2	0.27	6.85	1-1/16	27.0	0.69	17.5	1.84	46.7
1/2	12.70	Rc 1/4	0.37	9.4	3/4	19.1	0.92	23.3	1.71	43.4
1/2	12.70	Rc 3/8	0.37	9.4	7/8	22.2	0.92	23.3	1.79	45.5
1/2	12.70	Rc 1/2	0.37	9.4	1-1/16	27.0	0.92	23.3	2.04	51.8
5/8	15.87	Rc 1/2	0.50	12.7	1-1/16	27.0	0.97	24.7	2.09	53.1
3/4	19.05	Rc 1/2	0.59	15.0	1-1/16	27.0	0.97	24.7	2.08	52.8
3/4	19.05	Rc 3/4	0.59	15.0	1-5/16	33.3	0.97	24.7	2.16	54.9
3/4	19.05	Rc 1	0.59	15.0	1-5/8	41.3	0.97	24.7	2.30	58.4
1	25.40	Rc 3/4	0.80	20.3	1-5/16	33.3	1.30	33.0	2.39	60.7
1	25.4	Rc 1	0.8	20.3	1-5/8	41.3	1.3	33.0	2.53	64.3
1-1/4	31.75	Rc 1-1/4	1.02	25.9	2-1/8	54	1.72	43.9	3.06	77.7
1-1/2	38.1	Rc 1-1/2	1.25	31.8	2-3/8	60.3	2.06	52.5	3.5	88.9
2	50.8	Rc 2	1.72	43.7	2-7/8	73.03	2.73	69.4	4.22	107.44