

# CAP

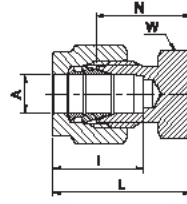

A Tube O.D.		W Hex. flat		N		L		I	
mm		mm		mm		mm		mm	
2		12		13.5		20.1		12.9	
3		12		13.5		20.1		12.9	
4		12		14.7		21.3		13.7	
6		14		15.7		23.1		15.3	
8		15		17.0		24.5		16.2	
10		18		19.0		26.6		17.2	
12		22		19.0		29.1		22.8	
15		24		19.8		29.9		24.4	
16		24		19.8		29.9		24.4	
18		27		21.3		31.4		24.4	
20		30		23.9		34.0		26.0	
22		30		23.9		34.0		26.0	
25		35		26.2		38.5		31.3	
28		41		27.7		48.5		36.6	
32		46		32.8		55.8		42.0	
38		55		37.8		65.4		49.4	

A Tube O.D.		W Hex. flat		N		L		I	
in	mm	in	mm	in	mm	in	mm	in	mm
1/16	1.58	5/16	7.9	0.44	11.17	0.59	14.98	0.34	8.6
1/8	3.17	7/16	11.1	0.53	13.46	0.79	20.06	0.5	12.7
3/16	4.76	7/16	11.1	0.58	14.73	0.84	21.84	0.54	13.7
1/4	6.35	1/2	12.7	0.63	16	0.92	23.37	0.6	15.3
5/16	7.93	9/16	14.3	0.67	17.01	0.96	24.38	0.64	16.2
3/8	9.52	5/8	15.9	0.72	18.28	1.01	25.65	0.66	16.9
1/2	12.7	13/16	20.6	0.75	19.05	1.15	29.21	0.9	22.9
5/8	15.87	15/16	23.8	0.78	19.81	1.18	29.97	0.96	24.4
3/4	19.05	1-1/16	27	0.84	21.33	1.24	31.49	0.96	24.5
7/8	22.22	1-3/16	30.2	0.94	23.88	1.34	34.04	1.02	25.9
1	25.4	1-3/8	34.9	1.03	26.16	1.51	38.35	1.23	31.2
1-1/4	31.75	1-3/4	44.5	1.23	31.24	2.1	53.34	1.62	41.2
1-1/2	38.1	2-1/8	54.0	1.47	37.33	2.54	64.52	1.97	50.0
2	50.8	2-3/4	69.9	1.94	49.28	3.41	86.61	2.66	67.6

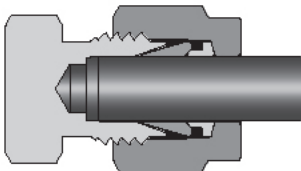

"D" - Dimension is minimum opening - dimensions are for reference only, and are subject to change without notice.  
For 1/16, 1/8 and 3/16 in 2, 3 and 4mm tube fittings, tighten the nut 3/4 turn.